



YETDA INDUSTRY LTD.

High Performance SMD Single-Color Top LEDs S776AW4

SMD with Super-Bright Dice.

High Reliability / Durable.

High Saturated Current (200mA).

High Power (0.25W).

High Esd (2000V Up).

Encapsulated with White Clear Color Package.

Absolute Maximum Ratings :

Parameter	Maximum Rating	Unit
Peak Forward Current	120	mA
Continuous Forward Current	30	mA
Operating Temperature Range	- 40 to + 85	
Storage Temperature Range	- 50 to + 100	
Lead Soldering Temperature	260 for 3 seconds 1.6mm(0.063 inch) from body	

Electro-Optical Characteristics (Ta = 25)

Parameter Radiant	Test Condition	Symbol	Min.	Typ.	Max.	Unit
Forward Voltage	If = 20mA	Vf	3.0	3.2		V
Reverse Current	Vr = 5V	Ir		5		uA
Luminous Intensity	If = 100mA	Iv	16.3	22.0		lm
Spectral Bandwidth	If = 20mA	$\Delta\lambda$				nm
Wavelength	If = 20mA	X		0.29		
		Y		0.30		
Half View Angle	If = 20mA	2 θ 1/2		120		deg

Please refer to CIE1931 Chromaticity Coordinate diagram

Package

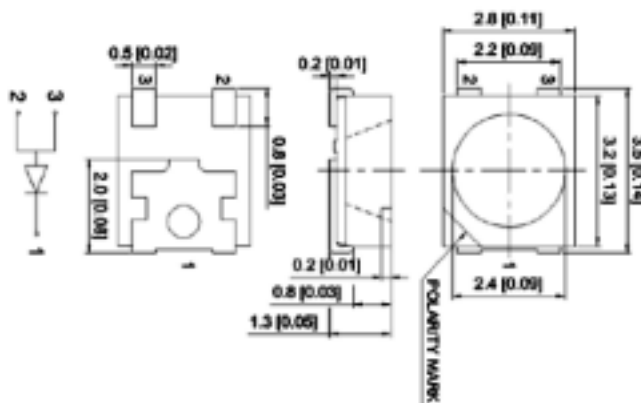

Unit: mm