

INFRARED EMITTING DIODE

紅外線發射二極體

302 Infrared LEDs

Part Number: IS1469TK

Package outlines

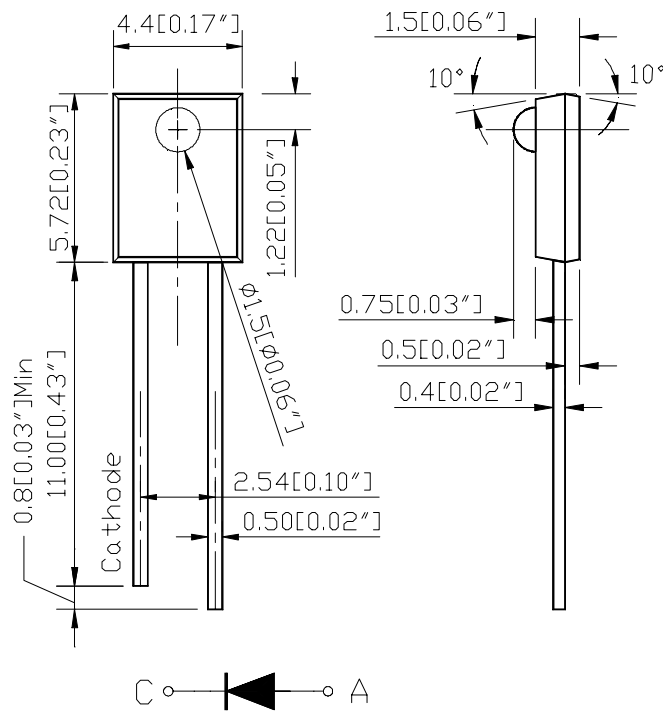

ITEM	MATERIALS
Resin (mold)	Epoxy
Bonding wire	Ø 25 µm Au
Lens color	Water transparent
Lead frame	Ag plating iron alloy
Dice	GaAlAs

NOTES:

1. All dimensions are in millimeters (inches);
2. Tolerances are $\pm 0.2\text{mm}$ (0.008inch) unless otherwise noted.

Part Number: IS1469TK

Absolute maximum ratings (T_A=25°C)

Parameter	Symbol	Value	Unit
Power dissipation	Pd	75	mW
Peak forward current Pulse width 100μs, duty cycle =1%	I _{fp}	1	A
Continuous forward current	I _f	50	mA
Reverse voltage	V _r	5	V
Operating temperature range	T _{op}	-20 ~+80	°C
Storage temperature range	T _{stg}	-20 ~+80	°C
Lead soldering temperature	T _{sol}	260°C for 5 SEC (5mm [0.20"] from body)	

Electro-optical characteristics (T_A=25°C)

Parameter	Test Condition	Symbol	Value			Unit
			Min	Typ	Max	
Chip radiant incidence	I _f =20mA	E _e	0.4	--	--	mW/cm ²
Forward voltage	I _f =20mA	V _f	--	1.30	1.80	V
Reverse current	V _r =5V	I _r	--	--	10	μA
Peak wavelength	I _f =20mA	λ _p	--	940	--	nm
Spectral bandwidth	I _f =20mA	Δλ	--	50	--	nm
View angle	I _f =20mA	2θ 1/2	--	40	--	Deg